

<p>BODY 107' ASL Tandem Axle Aluminum Body PUC COMPT, DRIVER SIDE FRONT FH/FD RollUp w/o Chute COMPT, DRIVER SIDE REAR FH/FD RollUp and Lift-up rearward COMPT, PASSENGER SIDE FRONT Full Height RollUp Forward COMPT, PASSENGER SIDE REAR Full Height RollUp and Liftup Rearward</p>	<p>WATER TANK 500 Gallon Notched Poly Water Tank Foam System Foam System Not Required Foam Cell Foam Cell Not Required</p>
--	---

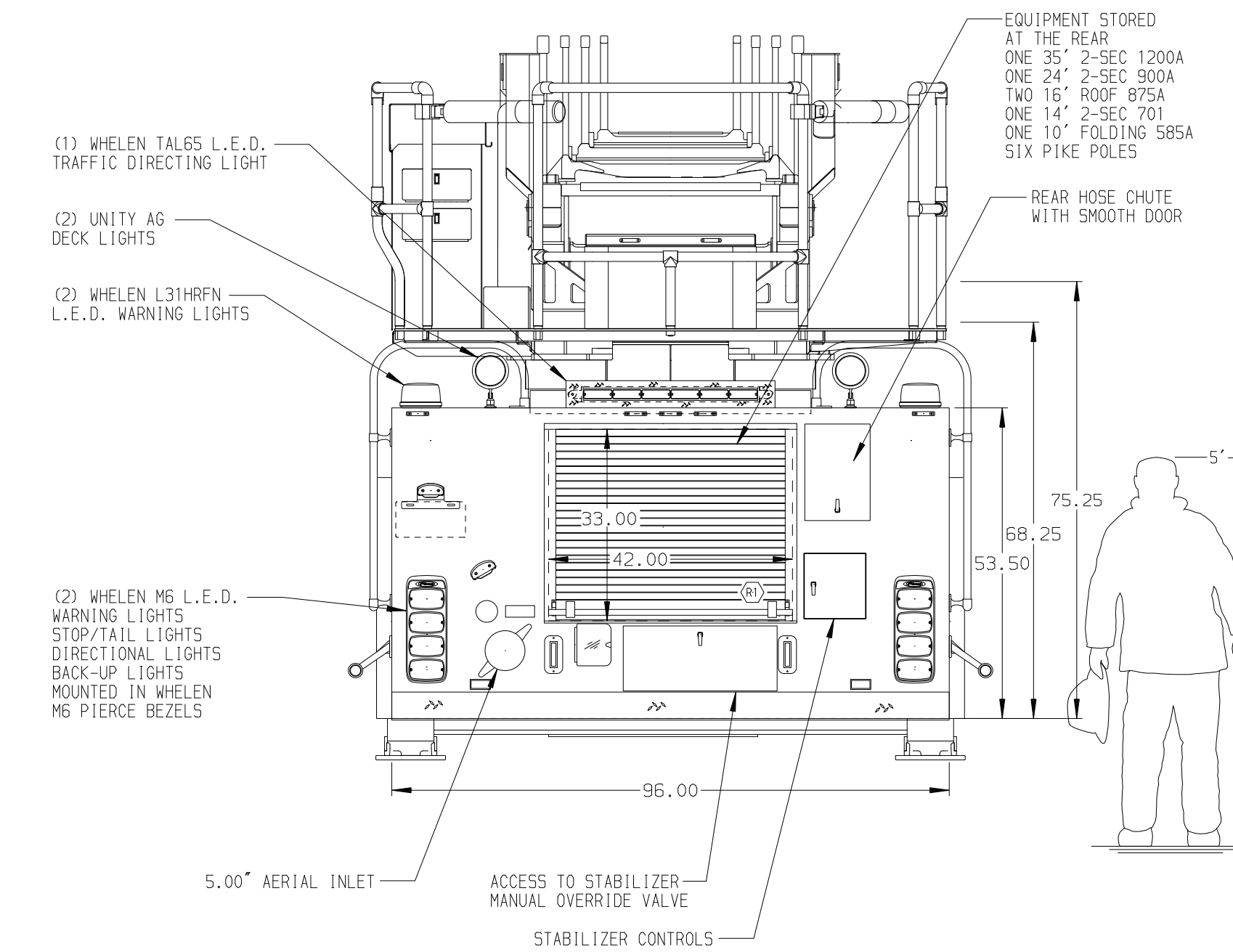
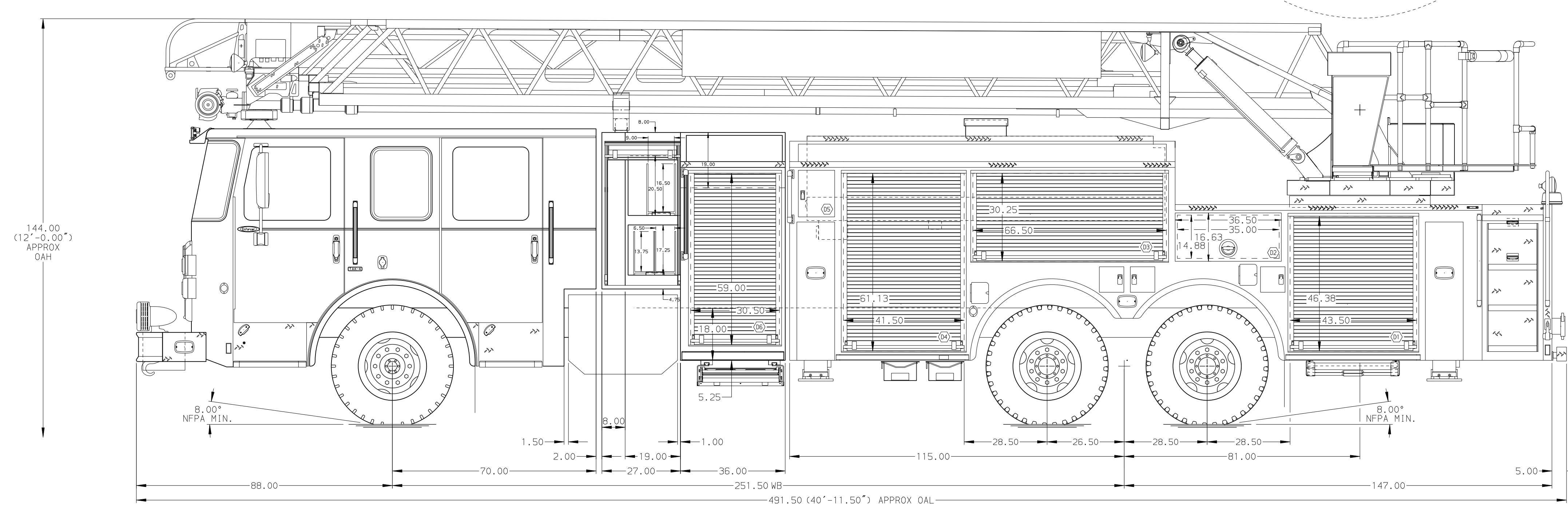

<p>CHASSIS Enforcer Chassis, PUC ENGINE 505 HP DD13 Engine</p>	<p>CAB 7000 Enforcer Cab, PUC BUMPER 19\"/> </p>	<p>AXLE, FRONT, CUSTOM 19,500 Lb TAK-4 Axle AXLE, REAR 44,000 Lb Meritor Axle</p>	<p>TRANSMISSION Allison 5th Gen, 4000 EVS P</p>	<p>PUMPHOUSE Control Zone, PAL/PAP PUC PUMP 1500 GPM Pierce PUC</p>	<p>CROSSLAYS, 1.50\"/> </p>	<p>SPEEDLAYS Speedlays Not Required GENERATOR Generator Not Required</p>	<p>SAFETY Side Roll and Frontal Impact Protection</p>	<p>CUSTOMER APPROVAL APPROVED BY: _____ DATE: _____</p>	<p>Pierce MANUFACTURING INC.</p>	<p>JOB NO. - SCALE 1:24 DATE - DRAWN BY - CHECKED BY - SHEET SIZE SHEET NO. D 1 OF 1</p>
<p>NOTE DIMENSIONS SHOWN ARE APPROXIMATE AND ARE SUBJECT TO MINOR DEVIATIONS AS MAY OCCUR OR BE NECESSARY IN CONSTRUCTION. MINOR DETAILS NOT SHOWN.</p>										
<p>1. ONE 1.50 OUTLET WITH 2.00 PIPING AND SWIVEL LOCATED IN CENTER BUMPER TRAY 2. SHORELINE RECEPTACLE WITH KUSSMAUL SUPER AUTO-EJECT LOCATED ON DRIVER SIDE OF THE CAB 3. AIR INLET WITH DISCONNECT COUPLING IN THE DRIVER SIDE STEPWELL 4. BATTERY CHARGER LOCATED IN COMPARTMENT D4 5. BATTERY CHARGE INDICATOR LOCATED ON THE DRIVER SIDE SEAT RISER 6. ADJUSTABLE SHELVES IN COMPARTMENTS PER SHOP ORDER 7. ONE FLOOR MOUNTED SLIDE-OUT TRAY LOCATED PER SHOP ORDER 8. 3.00\"/> </p>										